

Quick Start Guide



Home Assistant Connect ZBT-2

For more information,
visit go.nabucasa.com/zbt-2

1

Find a space where you can place the adapter upright.

Place the adapter in a vertical position. Do not mount on a wall sideways.

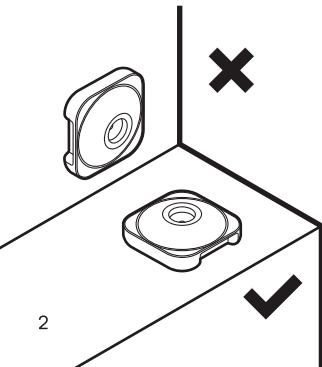

2

Screw the antenna to the base. Be careful not to overtighten, as this can damage the adapter beyond repair.



3

Plug the USB-C cable into
Connect ZBT-2.

4

Connect the USB cable to a
USB 2.0 or later port on a device
running Home Assistant 2025.11
or newer.

If you have not used Zigbee before,
Home Assistant should discover the
adapter.

Otherwise, please visit our
documentation to migrate your
current configuration.

go.nabucasa.com/zbt-2

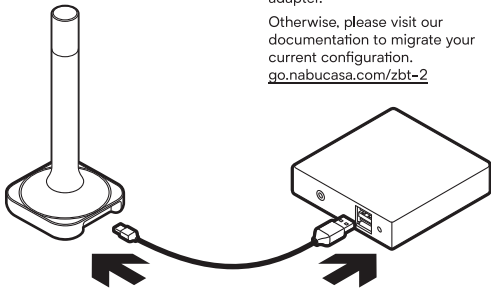

Where should I put it?

Place Connect ZBT-2 in a central location, away from materials or devices that may block radio transmission or cause interference.

✗ Wire mesh

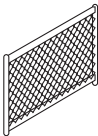

Body of water ✗

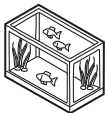

✗ Wireless transmitters

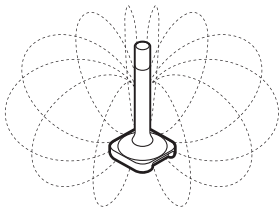

✗ USB 3.0 ports

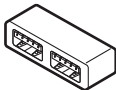

✗ SSDs



Thick walls ✗

